

# JUKI PICK UP NOZZLE

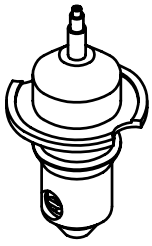

E3501-721-0A0  
(101)

I.D. =  $\phi 0.4$   
O.D. =  $\phi 1.0$

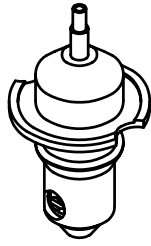

E3502-721-0A0  
(102)

I.D. =  $\phi 1.0$   
O.D. =  $\phi 1.5$

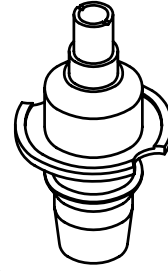

E3503-721-0A0  
(103) (ORI.)

I.D. =  $\phi 1.6$   
O.D. =  $\phi 3.0$

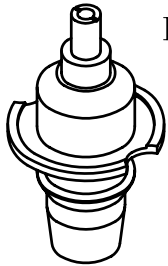

E3503-721-0A0  
(103) (MOD.)

I.D. =  $\phi 1.7$   
O.D. =  $\phi 3.0$

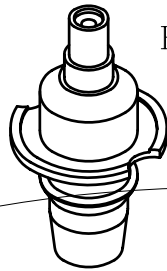

E3503-721-0A0  
(103) (MOD.)

I.D. =  $\phi 3.0$   
O.D. =  $\phi 4.0$

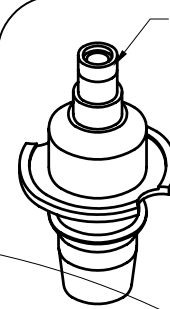

RUBBER TIP  
E3503-721-0A0  
(103) (MOD.)

I.D. =  $\phi 2.0$   
O.D. =  $\phi 3.0$

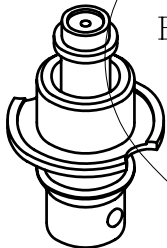

E3504-721-0A0  
(104)

I.D. =  $\phi 3.2$   
O.D. =  $\phi 4.0$

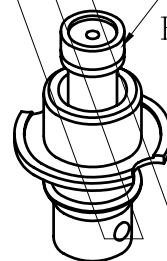

RUBBER TIP  
E3505-721-0A0  
(105)

I.D. =  $\phi 5.0$   
O.D. =  $\phi 6.5$

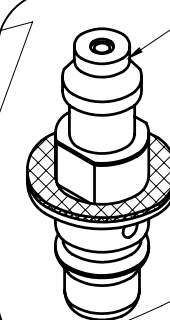

RUBBER TIP  
E3551-721-0A0  
(201)

I.D. =  $\phi 1.5$   
O.D. =  $\phi 3.5$

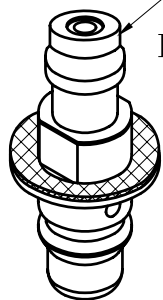

RUBBER TIP  
E3552-721-0A0  
(202)

I.D. =  $\phi 3.2$   
O.D. =  $\phi 5.5$

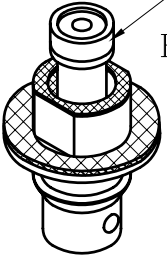

RUBBER TIP  
E3553-721-0A0  
(203)

I.D. =  $\phi 5.0$   
O.D. =  $\phi 8.5$

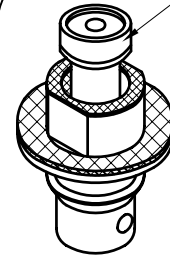

RUBBER TIP  
E3554-721-0A0  
(204)

I.D. =  $\phi 8.0$   
O.D. =  $\phi 9.5$

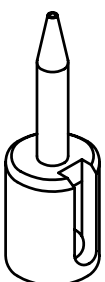

PICK-UP NOZZLE(STD)  
(1005 CHIP)  
JUKI 740 M/C

I.D. =  $\phi 0.4$   
O.D. =  $\phi 0.6$

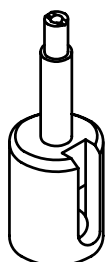

PICK-UP NOZZLE(STD)  
(MELF)  
JUKI 720 M/C

I.D. =  $\phi 0.8$   
O.D. =  $\phi 1.5$

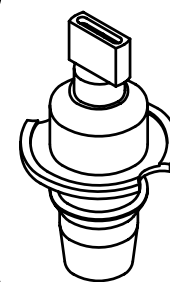

JUKI NOZZLE  
(CUSTOMIZE)